

# DRAIN-WAY® ABS DWV SYSTEMS

## PRODUCT INFORMATION BULLETIN

### In Use throughout North America for Three Decades

ABS-DWV (drain waste and vent) pipe and fittings have been used successfully for three decades in both underground and residential plumbing applications. Engineers and contractors have come to depend on the excellent corrosion resistance and durability of ABS. The number of ABS-DWV applications are increasing due to the development of certified firestopping devices. A broad range of DRAIN-WAY® ABS DWV pipe and fittings are available in nominal sizes from 1 1/4" to 6".

### Years of Maintenance-Free Service

ABS will not rust, pit or degrade when exposed to moisture and is extremely resilient and durable. This lightweight ABS-DWV offers easy and quick installation without specialized equipment, even in confined spaces.

### Complies with National and Provincial Standards and Building Codes

IPEX ABS-DWV pipe and fittings have withstood rigorous testing by the Canadian Standard Association (CSA) and have been certified to CSA B181.1.

With our knowledge of national and provincial building code requirements, we can provide our customers with comprehensive information regarding installation procedures as well as the broad range of applications for our ABS pipe and fittings. Our service includes working with engineers, designers, plumbing and building officials and, of course, the contractor, all this to ensure a smooth, trouble-free installation.

### Complete Line of Fittings

IPEX manufactures not only ABS-DWV pipe, but a complete line of ABS fittings, ensuring integrity throughout the plumbing system. In addition, our products are promptly available throughout any IPEX distributor.

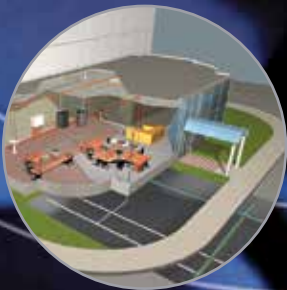

Products manufactured by IPEX Inc.  
DRAIN-WAY® ABS DWV is a registered trademark

Toll Free Canada: (866) 473-9462 | [ipexna.com](http://ipexna.com)