

## Endura® Lo-Pro Grease Interceptor

The Endura® Lo-PRO is ideal for those tight on-floor grease interceptor applications where space is at a premium. Based on the same dimensional footprint as our successful 35gpm and 50gpm Endura models, the 25gpm has an overall height of just 11 inches, and still meets the requirements of ASME112.14.3.

More importantly however, the internal components can be removed in less than 5" of additional clearance making this unit a truly low profile solution.

Sewer authorities and building owners spend millions of dollars every year combating grease accumulation in plumbing systems. Grease accumulation causes sewer blockages and overflows. These overflows are a health risk to you, your employees, your customers and the general public. Injection molded in engineered thermoplastic, the Endura® Grease Interceptor provides restaurant operators the best value and performance on the market.

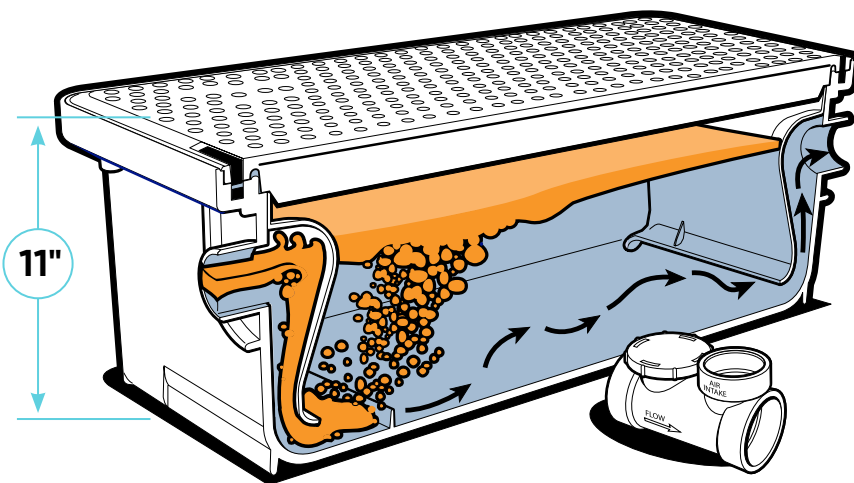

### Features and Benefits:

- EZ-Open cover latches include finger friendly detail simplifying access
- Unique & proven production process adds rigidity without the need for external ribs allowing smooth tank finish for ease of cleaning
- Improved grease separation efficiency for peace of mind & operational performance
- Minimum 5" clearance required for maintenance

### Standards:



ASME A112.14.3



### Contact us

Visit our website: [ipexna.com/](http://ipexna.com/)  
[enduragrease.com](http://enduragrease.com/)

Eastern U.S. Toll free: (800) 463-9572

Western U.S. Toll free: (888) 461-5307

Endura® is a registered trademark.

# Endura<sup>®</sup> Lo-Pro Grease Interceptor

Min. 5" clearance  
required for  
maintenance

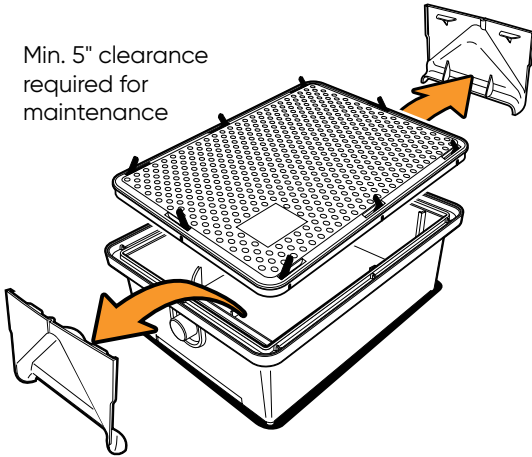

Contractor shall install an IPEX Endura<sup>®</sup> Lo-PRO Grease Interceptor, Part No. 3925A02LO. An accessible flow control with a rate of 25gpm will also be installed in accordance to manufacturer's instructions. The interceptor will be able to be serviced with a min. of 5" of overhead clearance. The unit shall be comprised of engineered thermoplastics to withstand operational temperatures up to 220°F (104°C) and incorporate a lid with the capability of supporting 440 lbs. (200 Kgs). The unit will be supported by a 10 year manufacturer's extended warranty. The grease interceptor shall be certified to the current version of the PDI-G101 standard and where locally applicable to ASME112.14.3 or have UPC listing. Contractor shall provide mechanical connectors to connect the grease interceptor.

## Dimensions

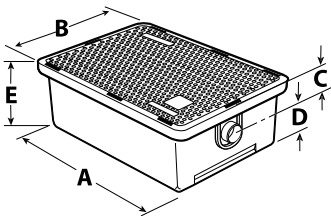

GPM/ lbs	# 3925A02LO 2" (25/50 LO Tank)
A	31.0" (787mm)
B	23.5" (597mm)
C	4" (102mm)
D	7" (178mm)
E	11" (279mm)

## Flow Control

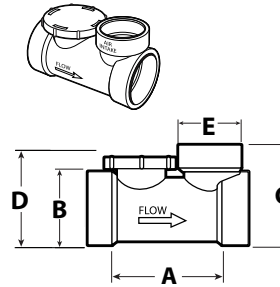

Connection Iron Pipe Size (Solvent Weld)	# 3922125CA 2" h x h
A	3.94" (100mm)
B	Dia. 2" (50.8mm)
C	3.44" (87.4)
D	3" (76mm)
E	Dia 1.5" (38.1mm)

## Capacity

Description	Endura 25 LO # 3925A02LO
US Gallons/Minute - GPM (L/Sec)	25 LO (1.6)
Minimum Grease Capacity - lb (kg)	50 (22.68)
Grease Capacity Actual - lb (kg) (ASME A112.14.3)	62.59 (28.39)
Average Efficiency % (ASME A112.14.3)	96.3%
Operating Temperature Capabilities	220°F (104°C)
Cover Load Rating - CSA B481.0 (L)	300 lb (135 kg)
Min. Test Load for Approval (L)	600 lb (270 kg)
Unit Weight (Empty) - lb (kg)	34.35 (15.58)
Liquid Capacity - gal (L)	18.9 (71.54)
Connection size (mechanical joint only)	2"

## Components

Item	Description	Part Number
1A	Latches (left)	3935A-6LH
1B	Latches (right)	3935A-6RH
2	Reinforced polypropylene cover	3935A-2
3	Rubber gasket	3935A-5
4	Removable polypropylene baffles	3925ALO-3
5	One-piece tank	3925A02LO-1

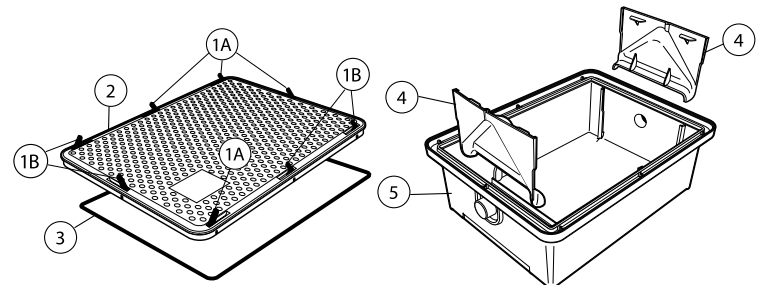

Technical Support:  
tech-support@endurainterceptor.com