

## Endura<sup>®</sup> Compact Grease Interceptors

Sewer authorities and building owners spend millions of dollars every year combating grease accumulation in plumbing systems. Grease accumulation causes sewer blockages and overflows, and are a health risk. Injection molded in engineered thermoplastic, the Endura<sup>®</sup> Grease Interceptor provides restaurant operators the best value and performance on the market.

The Endura compact platform includes 7gpm & 10gpm models along with our 15gpm model. All new models use a development of our patented baffle system to enhance separation performance at low flow rates. These units also feature the EZ-Clean exterior tank profile, a non-ribbed section for the lower two inches.



### Features and Benefits:

- Compact footprint compared to traditional solutions.
- Maximum service temperature rated at 220F 104C
- Molded one piece tank eliminates seams and potential leaking
- Recessed silicone seal prevents foul odors from escaping in service
- Cover is provided with an easy open latch system

### Standards:



NSF Certified  
to CSA B 481.1



ASME  
A112.14.3



PDI G101

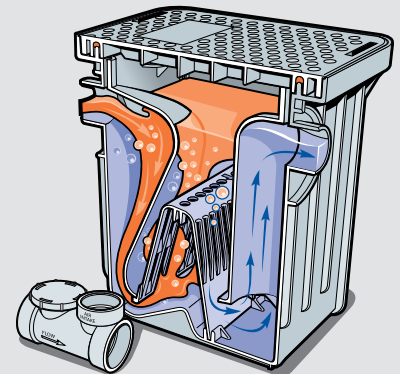

### Contact us

Visit our website: [ipexna.com / enduragreasemanagement.com](http://ipexna.com/enduragreasemanagement.com)

Eastern U.S. Toll free: (800) 463-9572

Western U.S. Toll free: (888) 461-5307

Endura<sup>®</sup> is a registered trademark.

# Endura® Compact Grease Interceptors

Contractor shall install a Canplas Endura® Grease Interceptor, Part No. \_\_\_\_\_. An accessible flow control with a rate of \_\_\_\_\_ gpm will also be installed in accordance to manufacturer's instructions. The unit shall be comprised of engineered thermoplastics to withstand operational temperatures up to 220°F (104°C) and incorporate a lid with air tight seal and the capability of supporting 440 lbs. (200 Kgs). The unit will be supported by a 10 year manufacturer's extended warranty. The grease interceptor shall be certified to the current version of the PDI-G101 or CSA B481 standards and where locally applicable to ASME112.14.3 and IAMPO listing will apply. Contractor shall provide two mechanical joint couplings to connect the grease interceptor.

## Dimensions

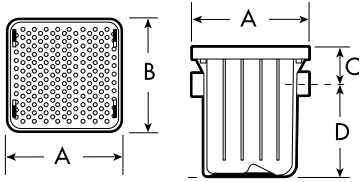

	7/14 GPM/lbs	10/20 GPM/lbs	15/30 GPM/lbs
A	14.5" (368mm)	14.5" (368mm)	14.5" (368mm)
B	17.5" (444mm)	17.5" (444mm)	17.5" (444mm)
C	3.5" (89mm)	3.5" (89mm)	3.5" (89mm)
D	12.8" (325mm)	12.8" (325mm)	12.8" (325mm)
E	16.3" (414mm)	16.3" (414mm)	16.3" (414mm)

## Flow Control

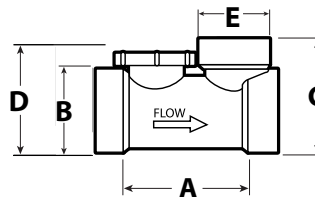

Connection Iron Pipe Size (Solvent weld)	2" h x h
A	3.94" (100 mm)
B	Nom. Dia. 2" (50.8 mm)
C	3.44" (87.4 mm)
D	3" (76 mm)
E	Nom. Dia. 1.5" (38.1 mm)

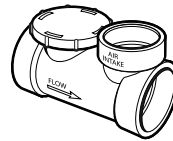

Part No:	Description	Ctn. Qty.
3922107C	2" 7 GPM (.44 LPS)	1
3922110C	2" 10 GPM (.63 LPS)	1
3922115C	2" 15 GPM (.94 LPS)	1

## Capacity

US Gallons Per Minute (GPM)	7	10	15 Compact
Capacity - Pounds	14	20	30
Litres Per Second (LPS)	0.44	0.63	0.94
Capacity - Kilograms	6.35	9.07	13.6
Average Efficiency % (ASME 112.4.3)	95.5%	92.5%	92.0%
Part Number	3907A02	3910A02	3915A02C
Grease Capacity lbs (Kg) actual	31.95 lbs (14.49 kgs)	38.1 lbs (17.28 kgs)	40.97 lbs (18.58 kgs)
Operating Temperature Capabilities	220°F (104°C)	220°F (104°C)	220°F (104°C)
Surface Load Capacity	440 lbs (200 kgs)	440 lbs (200 kgs)	440 lbs (200 kgs)
Unit Weight (Empty)	13.8 lbs (6.26 kgs)	13.8 lbs (6.26 kgs)	13.8 lbs (6.26 kgs)
Liquid Capacity	12.96 gal (49.06 L)	12.96 gal (49.06 L)	12.96 gal (49.06 L)
Connection size (mechanical)	2"	2"	2"

## Components

Item	Description	Part No:
1	Latches	3920A-9
2	Reinforced polypropylene cover	3910A-2
3	Rubber gasket	3910A-5
4	Removable Outlet Baffle	3910A-4
5	Removable Inlet Baffle	3920A03-3
6	Directional Diffuser	3910A-3
7	One-piece tank	3910A-1

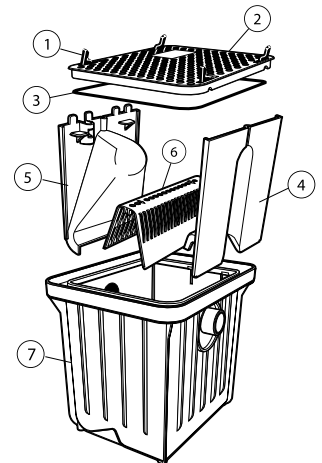

Now supplied with compact flow control.

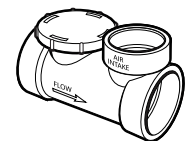

Technical Support:  
tech-support@endurainterceptor.com